

# GPS-C 2R/70/FM

GPS Antenna with Whip with Shock Spring for the 160 MHz, 450 MHz and FM Bands

## DESCRIPTION

- External antenna whip mounted on the GPS-Combi mount.
  - Black-chromed, conical stainless steel whip.
  - Sturdy, general-purpose  $\frac{1}{4}$   $\lambda$  antenna in professional quality.
  - Easily removable whip for car wash.
- GPS-antenna for fixed installations.
  - Full hemispherical coverage.
  - Built-in high gain, low noise amplifier.
  - Right-Hand Circularly Polarized antenna (RHCP).
  - 5 V supply voltage (3 V respectively 12 V available on request).
  - DC supply via RF-connector.

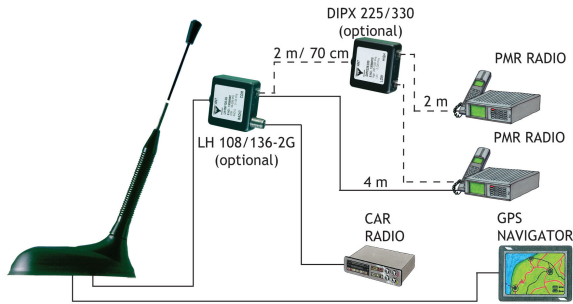

## ORDERING DESIGNATIONS

TYPE	PRODUCT NO.
GPS-C 2R/70/FM	132000061
LH 108/136-2G (optional)	200000762
DIPX 225/330-FME (optional)	200000670

## SPECIFICATIONS FOR WHIP

ELECTRICAL	
MODEL	GPS-C 2R/70/FM
ANTENNA TYPE	Mobile antenna
FREQUENCY	2 m: 145 MHz 70 cm: 435 MHz FM band: 88-108 MHz
IMPEDANCE	Nom. 50 $\Omega$
POLARIZATION	Vertical
BANDWIDTH	2 m: 20 MHz 70 cm: 40 MHz @ SWR $\leq$ 2.0
SWR	$\leq$ 1.3 @ f.res.
MAX. POWER	25 W
MECHANICAL	
MATERIALS	Whip: Black-chromed, conical stainless steel Black-chromed brass Spring: Black-chromed stainless steel
COLOUR	Black
HEIGHT	492 mm
WEIGHT	50 g
MOUNTING	On the GPS-Combi mount

## SPECIFICATIONS FOR GPS-COMBI MOUNT

ELECTRICAL GENERAL SPECIFICATIONS	
MODEL	GPS-COMBI MOUNT
ANTENNA TYPE	Active patch antenna
FREQUENCY	1575 MHz
IMPEDANCE	Nom. 50 $\Omega$
POLARIZATION	Circular right-hand
COVERAGE	Hemispherical
GAIN	28 dBic in axial direction (typ.)
CROSS-POLARIZATION ATT.	> 10 dB (typ.)
SELECTIVITY	> 45 dB down @ $\pm$ 45 MHz
BUILT-IN AMPLIFIER	
GAIN	> 30 dB (typ.)
NOISE FIGURE	< 1 dB (typ.)
P <sub>1dB</sub>	Approx. +7 dBm
SWR (output)	$\leq$ 2.0
SUPPLY VOLTAGE	5 $\pm$ 0.5 VDC (3 V resp. 12 V on request)
CURRENT CONSUMPTION	Approx. 25 mA
MECHANICAL (ONLY FOR THE GPS-PART)	
MATERIALS	Cu-nite brass Stainless steel Reinforced thermoplastic
ANTENNA COLOUR	Black
TEMP. RANGE	-35° C $\rightarrow$ +75° C
CONNECTOR	FME (male for GPS) + FME (female for mobile antenna)
RECOMMENDED INSTALL. TORQUE	4 $\pm$ 0.5 Nm
DIMENSIONS (H x L)	Approx. 30 x 89 mm
ROOF THICKNESS	Max. 2.5 mm
WEIGHT	Approx. 114 g
MOUNTING	$\phi$ 18.0 mm dia. hole for roof thickness up to 2.0 mm $\phi$ 18.5 mm dia. hole for roof thickness 2.0 - 2.5 mm Tools for mounting included

## MOUNTING INSTRUCTIONS

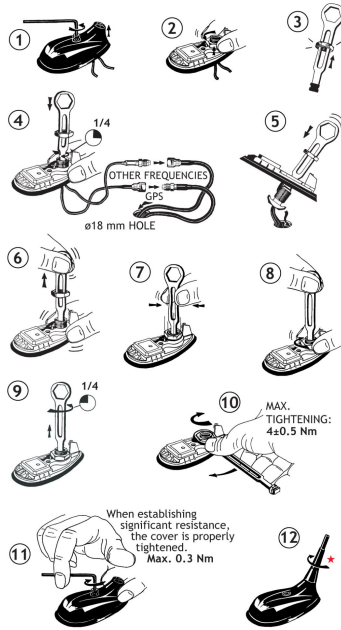

★ The whip should always be dismantled during car wash.

Do not use sealer on rubber gasket or other places.

## CABLE MOUNTING

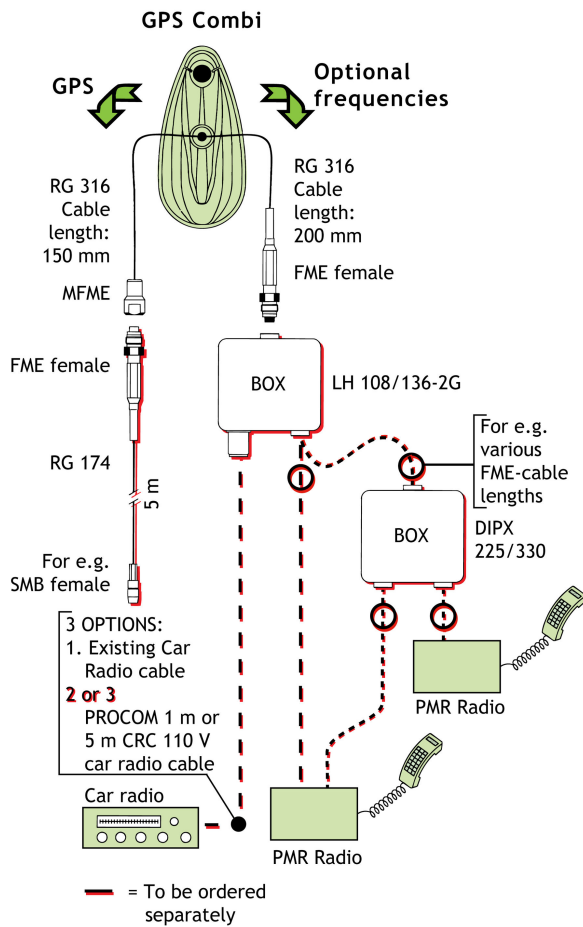

## TYPICAL RESPONSE CURVES

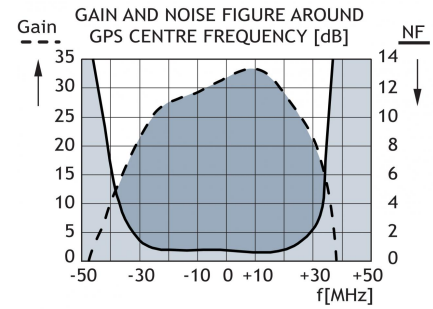
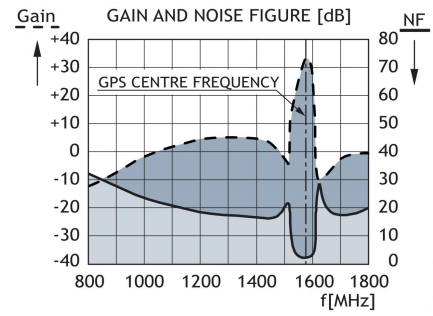

## VERTICAL RADIATION PATTERN

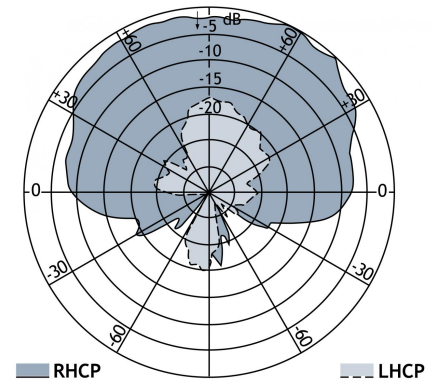

PROCOM A/S reserve the right to amend specifications without prior notice.  
22/08/13