

# GPS-C 4/2/TETRA-S BBMU/...

Collinear Mobile Antenna for the 4m, 2m and TETRA Bands

## DESCRIPTION

- External antenna whip mounted on the GPS-Combi mount.
  - Polyethylene-covered flexible whip.
  - Easily removable whip for car wash.
- GPS-antenna for fixed installations.
  - Full hemispherical coverage.
  - Built-in high gain, low noise amplifier.
  - Right-Hand Circular Polarization antenna (RHCP).
  - 5 V supply voltage (3 V respectively 12 V available on request).
  - DC supply via RF-connector.
  - Matching unit (BBMU) included.

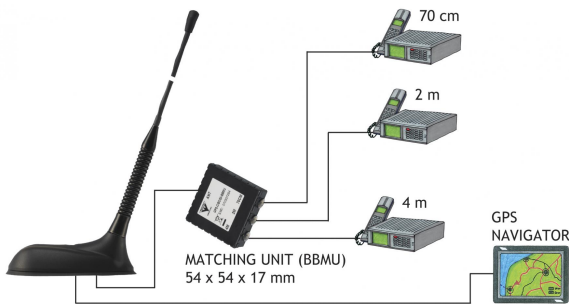

## ORDERING DESIGNATIONS

TYPE	PRODUCT NO.	ROOF THICKNESS
GPS-C 4/2/TETRA-S BBMU	132000084	Max. 2.5 mm
GPS-C 4/2/TETRA-S BBMU/7mm	132000096	3.5 - 7.5 mm

## SPECIFICATIONS FOR WHIP

ELECTRICAL	
MODEL	GPS-C 4/2/TETRA-S BBMU/...
ANTENNA TYPE	Collinear mobile whip antenna
FREQUENCY	4 m: 74.2 - 87.5 MHz 2 m: 167.5 - 174 MHz 70 cm: 380 - 400 MHz
SWR	74.2 - 77.7 and 84 - 87.5 MHz: $\leq 2.5$ 167.5 - 169.5 and 172 - 174 MHz: $\leq 2.0$ 380 - 400 MHz: $\leq 2.0$
IMPEDANCE	Nom. 50 $\Omega$
POLARIZATION	Vertical
GAIN	4 m: approx. -3 dB 2 m: approx. -4 dB 70 cm: approx. 2 dB (acc. to EIA RS-329-1)
MAX. POWER	25 W
MECHANICAL	
MATERIALS	Whip: Glass fibre whip with copper wire winding, polyethylene-covered. Black-chromed brass Spring: Black-chromed stainless steel
COLOUR	Black
HEIGHT	670 mm
WEIGHT	60 g
MOUNTING	On the GPS-Combi mount

## SPECIFICATIONS FOR GPS-COMBI MOUNT

ELECTRICAL GENERAL SPECIFICATIONS	
MODEL	GPS-COMBI MOUNT
ANTENNA TYPE	Active patch antenna
FREQUENCY	1575 MHz
IMPEDANCE	Nom. 50 $\Omega$
POLARIZATION	Circular right-hand
COVERAGE	Hemispherical
GAIN	28 dBic in axial direction (typ.)
CROSS-POLARIZATION ATT.	> 10 dB (typ.)
SELECTIVITY	> 45 dB down @ $\pm 45$ MHz
BUILT-IN AMPLIFIER	
GAIN	> 30 dB (typ.)
NOISE FIGURE	< 1 dB (typ.)
P1 dB	Approx. +7 dBm
SWR (output)	$\leq 2.0$
SUPPLY VOLTAGE	5 $\pm$ 0.5 VDC (3 V resp. 12 V on request)
CURRENT CONSUMPTION	Approx. 25 mA
MECHANICAL (ONLY FOR THE GPS-PART)	
MATERIALS	Cu-nite brass. Stainless steel Reinforced thermoplastic
ANTENNA COLOUR	Black
TEMP. RANGE	-35° C $\rightarrow$ +75° C
CONNECTOR	FME (male for GPS) + FME (female for mobile antenna)
RECOMMENDED INSTALL. TORQUE	4 $\pm$ 0.5 Nm
DIMENSIONS (H x L)	Approx. 30 x 89 mm
ROOF THICKNESS	Max. 2.5 mm or 3.5 - 7.5 mm
WEIGHT	Approx. 114 g
MOUNTING	$\varnothing$ 18 mm dia. hole for roof thickness up till 2.0 mm $\varnothing$ 18.5 mm dia. hole for roof thickness 2.0 - 2.5 mm $\varnothing$ 19 mm dia. hole for roof thickness 3.5 - 7.5 mm Tools for mounting included

MOUNTING INSTRUCTIONS

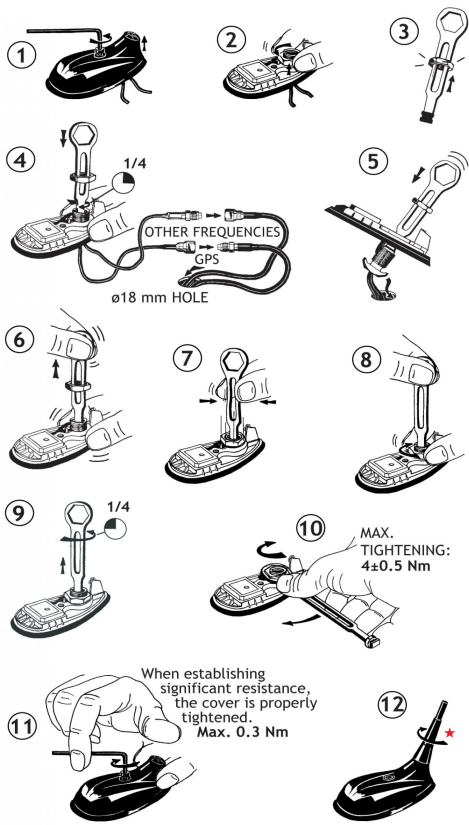

★ The whip should always be dismantled during car wash.

Do not use sealer on rubber gasket or other places.

CABLE MOUNTING

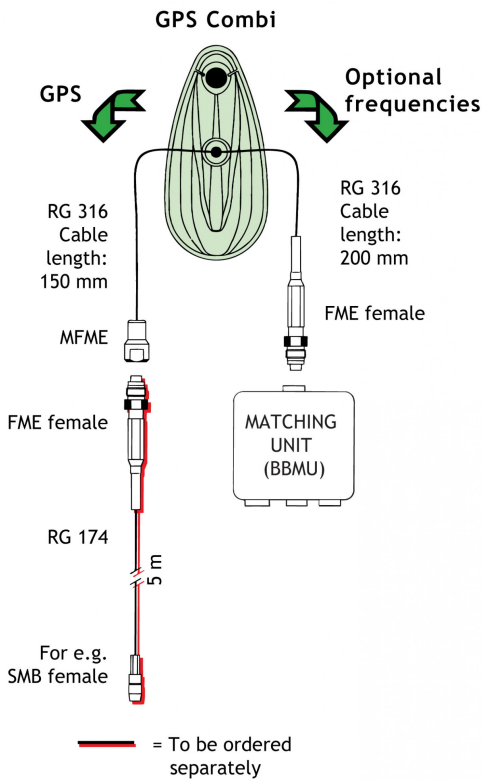

TYPICAL RESPONSE CURVES

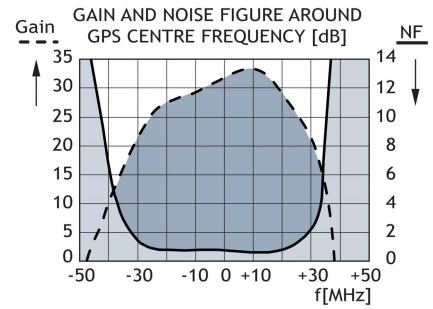
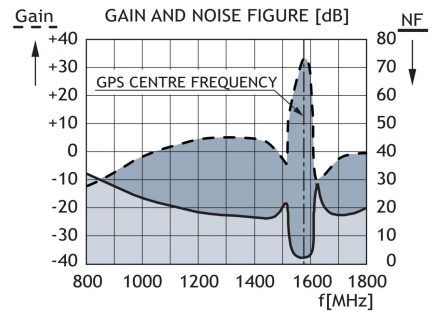

VERTICAL RADIATION PATTERN

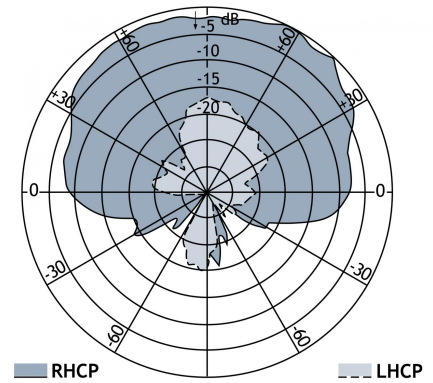

PROCOM A/S reserve the right to amend specifications without prior notice.  
30/07/15