

GPS-C MU 3/TETRA/I

GPS Antenna with 3 dB Whip for the TETRA Band

- External antenna whip mounted on the GPS-Combi mount.
 - Black-chromed, stainless steel whip.
 - 3 dB Gain for the TETRA Band.
 - Easily removable whip for car wash.
- GPS-antenna for fixed installations.
 - Full hemispherical coverage.
 - Built-in high-gain, low-noise amplifier.
 - Right-Hand Circular Polarization (RHCP).
 - 5 V supply voltage (3 V respectively 12 V available on request).
 - DC supply via RF-connector.

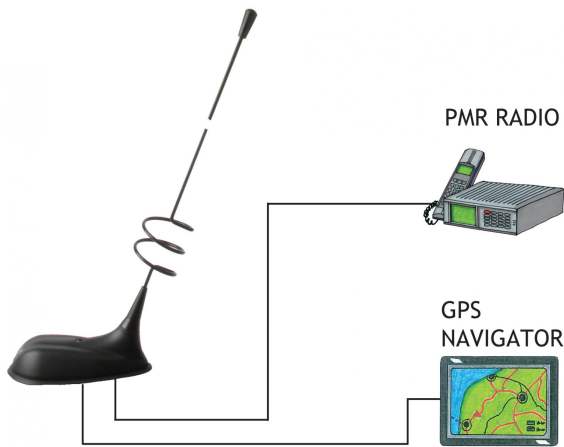

ORDERING DESIGNATIONS

TYPE	PRODUCT NO.
GPS-C MU 3/TETRA/I	132000130

SPECIFICATIONS FOR WHIP

ELECTRICAL	
MODEL	GPS-C MU 3/TETRA/I
ANTENNA TYPE	5/8 λ mobile whip antenna
FREQUENCY	380 - 400 MHz
IMPEDANCE	Nom. 50 Ω
POLARIZATION	Vertical
GAIN	Approx. 3 dB (acc. to EIA RS-329-1)
BANDWIDTH	≥ 20 MHz @ SWR ≤ 2.5
SWR	≤ 1.5 @ f.res.
MAX. POWER	25 W
MECHANICAL	
MATERIALS	Whip: Black-chromed, conical stainless steel Spring: Black-chromed brass
COLOUR	Black
HEIGHT	Approx. 450 mm
WEIGHT	Approx. 60 g
MOUNTING	On the GPS-Combi mount

SPECIFICATIONS FOR GPS-COMBI MOUNT

ELECTRICAL GENERAL SPECIFICATIONS	
MODEL	GPS-COMBI MOUNT
ANTENNA TYPE	Active patch antenna
FREQUENCY	1575 MHz
IMPEDANCE	Nom. 50 Ω
POLARIZATION	Circular right-hand
COVERAGE	Hemispherical
GAIN	28 dBic in axial direction (typ.)
CROSS-POLARIZATION ATT.	> 10 dB (typ.)
SELECTIVITY	> 45 dB down @ ± 45 MHz
BUILT-IN AMPLIFIER	
GAIN	> 30 dB (typ.)
NOISE FIGURE	< 1 dB (typ.)
P 1dB	Approx. +7 dBm
SWR (output)	≤ 2.0
SUPPLY VOLTAGE	5 ± 0.5 VDC (3 V resp. 12 V on request)
CURRENT CONSUMPTION	Approx. 25 mA
MECHANICAL (ONLY FOR THE GPS-PART)	
MATERIALS	Cu-nite brass Stainless steel Reinforced thermoplastic
ANTENNA COLOUR	Black
TEMP. RANGE	-35° C → +75° C
CONNECTOR	FME (male for GPS) + FME (female for mobile antenna)
RECOMMENDED INSTALL. TORQUE	4 ± 0.5 Nm
DIMENSIONS (H x L)	Approx. 30 x 89 mm
ROOF THICKNESS	Max. 2.5 mm
WEIGHT	Approx. 114 g
MOUNTING	∅18.0 mm dia. hole for roof thickness up to 2.0 mm ∅18.5 mm dia hole for roof thickness 2.0 - 2.5 mm Tools for mounting included

MOUNTING INSTRUCTIONS

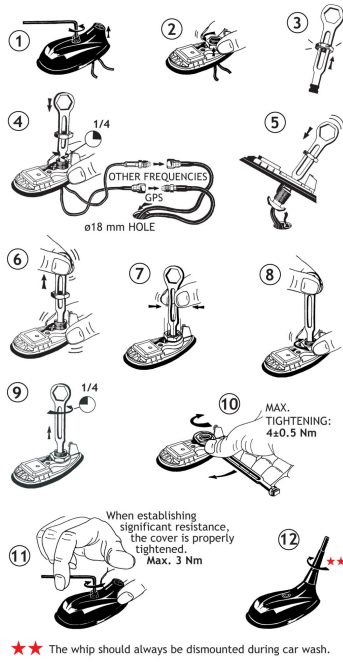

TYPICAL RESPONSE CURVE

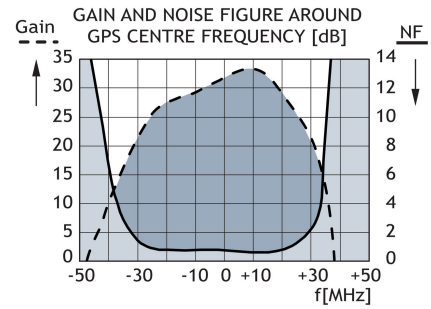
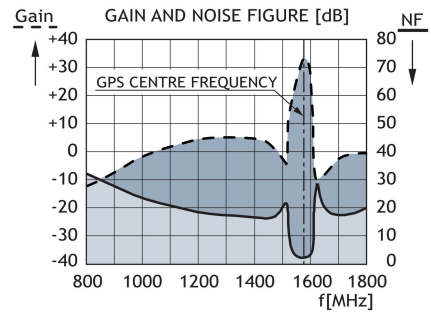

CABLE MOUNTING

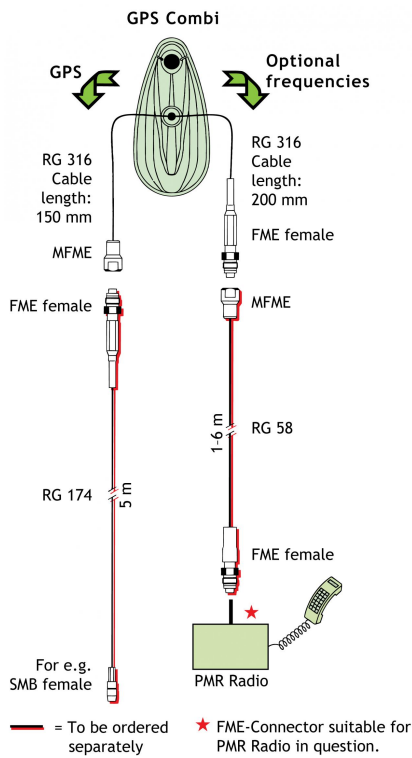

VERTICAL RADIATION PATTERN

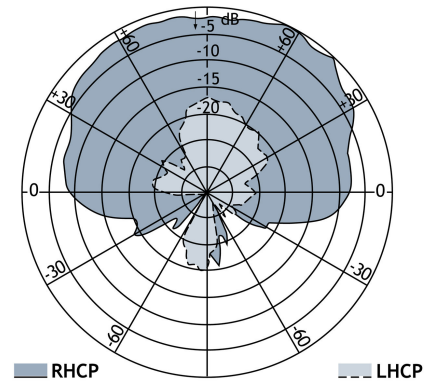

PROCOM A/S reserve the right to amend specifications without prior notice.
12/01/15