

Crankset FC-TY501

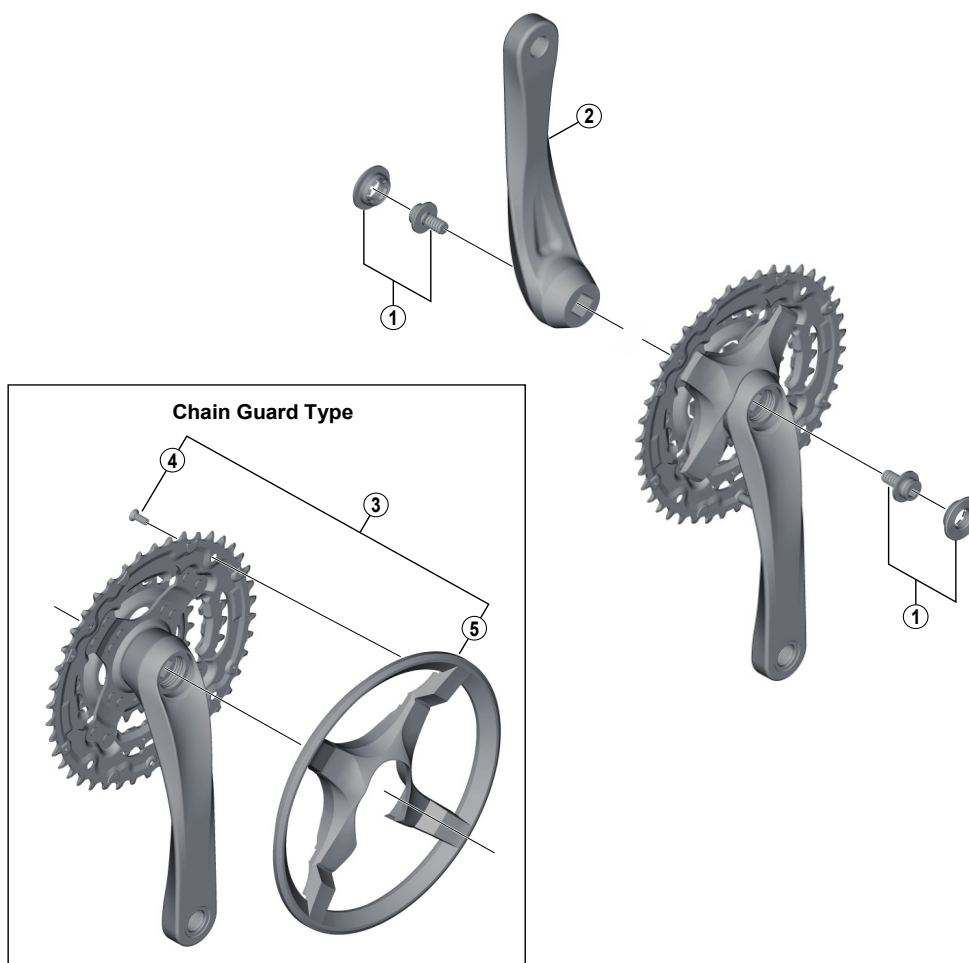

• Chaining teeth combinations: 42-34-24T / 48-38-28T

| ITEM NO. | SHIMANO CODE NO. | DESCRIPTION | INTERCHANGEABILITY | |
|----------|------------------|--|--------------------|----------|
| | | | FC-TY701 | FC-TY301 |
| 1 | Y1R598010 | Crank Arm Fixing Bolt & Cap | | |
| | Y1R507100 | Left Hand Crank Arm 165 mm (Silver) | B | B |
| 2 | Y1R505100 | Left Hand Crank Arm 170 mm (Silver) | B | B |
| | Y1R503100 | Left Hand Crank Arm 175 mm (Silver) | B | B |
| | Y1R507110 | Left Hand Crank Arm 165 mm (Black) | B | B |
| | Y1R505110 | Left Hand Crank Arm 170 mm (Black) | B | B |
| | Y1R503110 | Left Hand Crank Arm 175 mm (Black) | B | B |
| 3 | Y1R598020 | 42T Chain Guard (Silver) & Fixing Screws | | |
| | Y1R598030 | 42T Chain Guard (Black) & Fixing Screws | | |
| | Y1R598040 | 48T Chain Guard (Silver) & Fixing Screws | | |
| | Y1R598050 | 48T Chain Guard (Black) & Fixing Screws | | |
| 4 | Y1D298010 | Chain Guard Fixing Screw (4 pcs.) | A | A |
| | Y1R510000 | 42T Chain Guard (Silver) | | |
| 5 | Y1R510010 | 42T Chain Guard (Black) | | |
| | Y1R511000 | 48T Chain Guard (Silver) | | |
| | Y1R511010 | 48T Chain Guard (Black) | | |

A: Same parts.

B: Parts are usable, but differ in materials, appearance, finish, size, etc.

Absence of mark indicates non-interchangeability.

Specifications are subject to change without notice.

Sep.-2017-3832A

© Shimano Inc. I

SHIMANO