

DEORE Rapidfire Plus Lever SL-T6000 (3x10-speed)

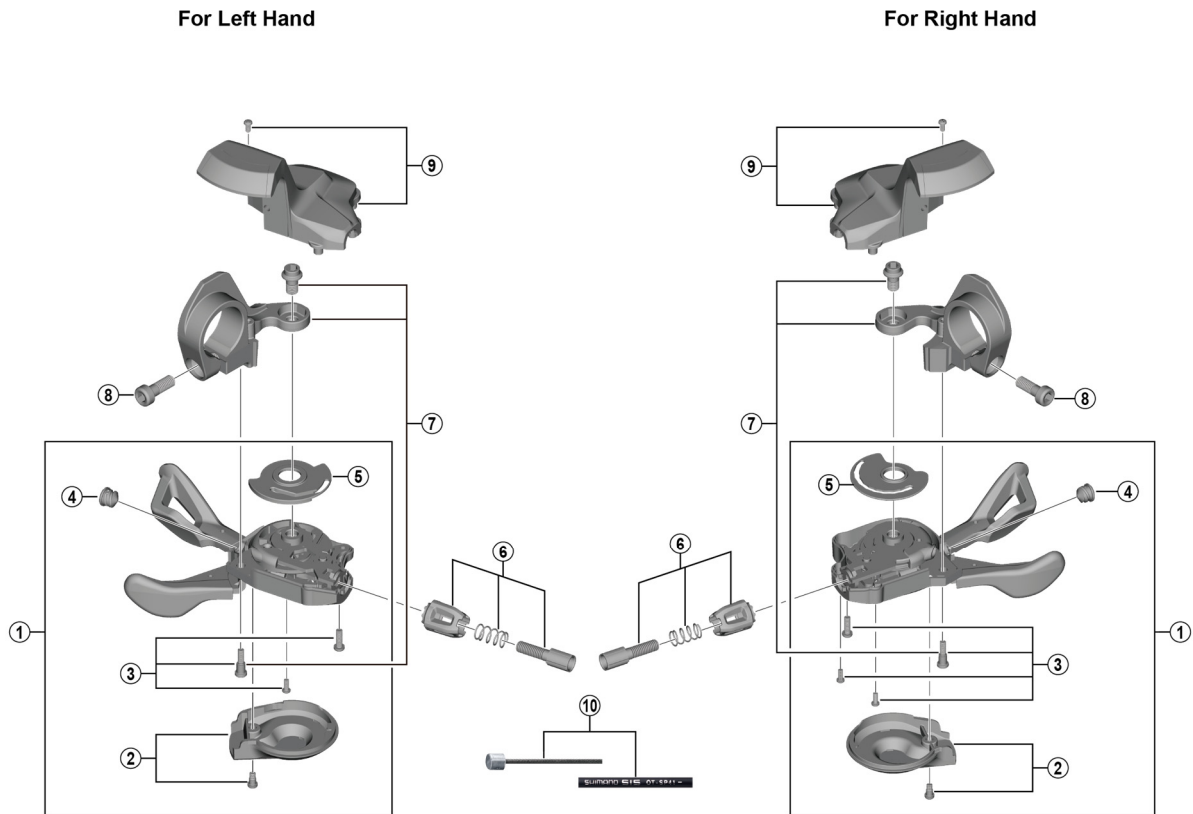

SL-T610

ITEM NO.	SHIMANO CODE NO.	DESCRIPTION	INTERCHANGEABILITY	
1	Y0CT98010	R.H. Shifting Lever Unit		
	Y0CU98010	L.H. Shifting Lever Unit		
2	Y0CT98020	R.H. Main Lever Cover & Fixing Screw		
	Y0CU98020	L.H. Main Lever Cover & Fixing Screw		
3	Y0CR98070	R.H. Base Cover Fixing Screw Unit		
	Y0CS98070	L.H. Base Cover Fixing Screw Unit		
4	Y6CD33000	Inner Hole Cap	A	
5	Y06P05000	R.H. Cam Plate		
	Y06N55000	L.H. Cam Plate		
6	Y03K98030	R.H. Cable Adjusting Bolt Unit		
	Y06N98040	L.H. Cable Adjusting Bolt Unit		
7	Y0CR98030	R.H. Bracket & Fixing Bolt		
	Y0CS98030	L.H. Bracket & Fixing Bolt		
8	Y6T842000	Clamp Bolt (M5 x 13.5)	A	
	Y0CT98030	R.H. Indicator Unit (Black)		
	Y0CT98040	R.H. Indicator Unit (Silver)		
	Y0CU98030	L.H. Indicator Unit (Black)		
9	Y0CU98040	L.H. Indicator Unit (Silver)		
	Y0CU98040	L.H. Indicator Unit (Silver)		
10	Y60198090	OT-SP41 OPTISLICK shift cable sets (Black) • Sealed outer caps, plastic (9 pcs.) • Sealed outer cap nose (1 pc.) • Rubber shield (1 pc.) • Inner end caps (2 pcs.)		
	Y60198091	OT-SP41 OPTISLICK shift cable sets (White) • Sealed outer caps, plastic (9 pcs.) • Sealed outer cap nose (1 pc.) • Rubber shield (1 pc.) • Inner end caps (2 pcs.)		

A: Same parts.

B: Parts are usable, but differ in materials, appearance, finish, size, etc.

Absence of mark indicates non-interchangeability.

Specifications are subject to change without notice.

Jun.-2017-4201

© Shimano Inc. I

SHIMANO