

BOMBAS CIRCULADORAS

Modelos:

RS15/60 // RS25/60 // RS25/80

- E** Fenco declara que estas bombas están conformes a las siguientes directivas europeas:
- GB** Fenco declares that these pumps are in conformity with the following directives:
- F** Fenco déclare que ces produits sont en conformité avec les directives de l'Union Européenne suivantes:
- P** A Fenco declara que estes produtos estão em conformidade com as seguintes directivas EU:

Directiva de Bajo voltaje (2006/95/EC)

Normas usadas: EN 60335-1:2002 y EN 60335-2-51:2003

EMC Directiva (2004/108/EC). Normas usadas: EN 61000-6-2 y EN 61000-6-3



< 43dB(A)

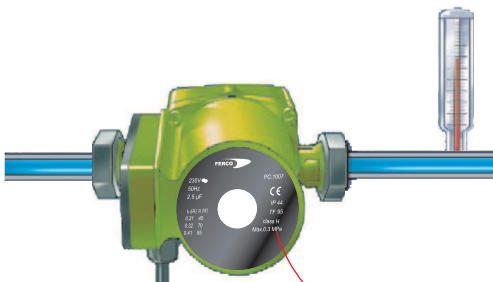

t min.: -25°C
t max.: +95°C



OK



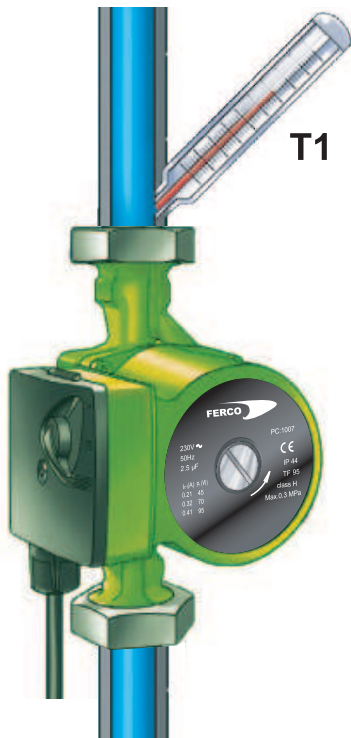





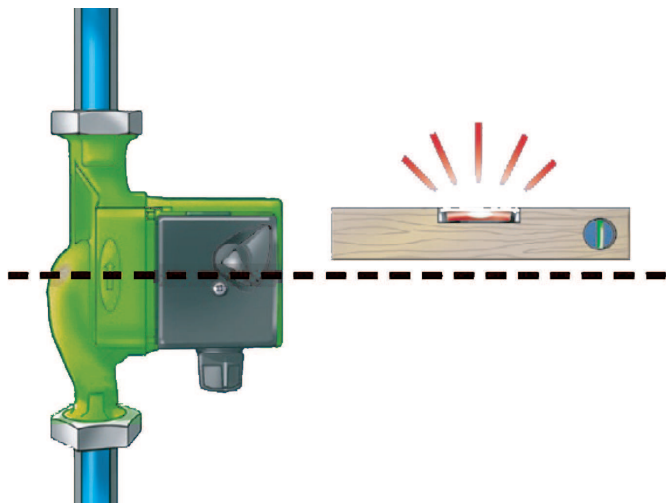

T1

T2



T1 ≥ T2								
T1 °C	2	40	60	80	90	100	105	110
Max T2 °C	0	40	40	40	40	40	40	40



OK	OK	OK	OK	(OK)
				

1

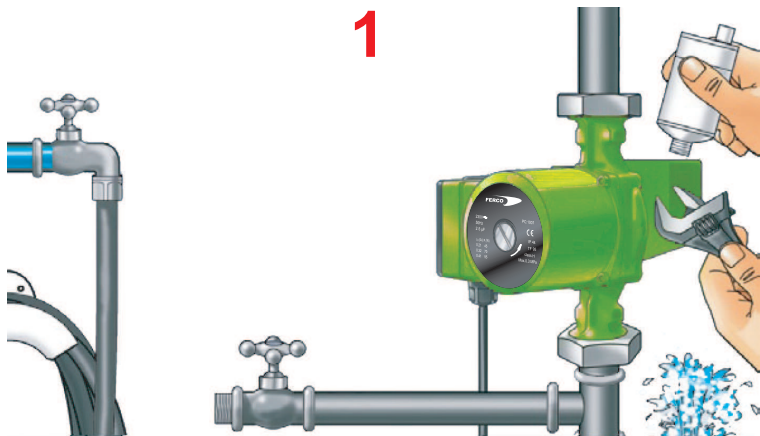

2

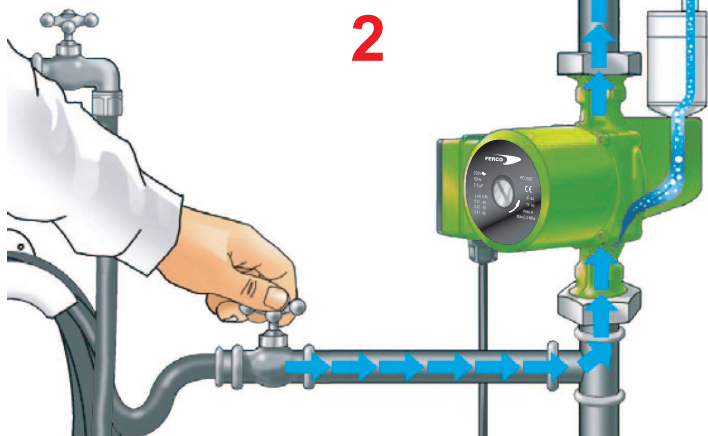

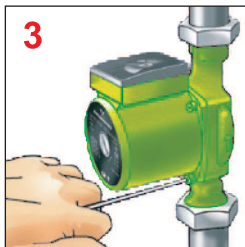
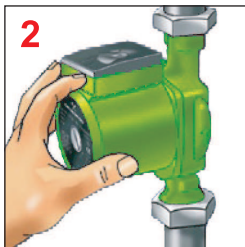
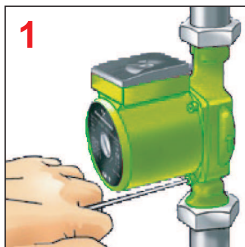
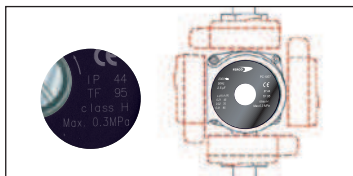
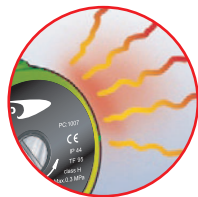
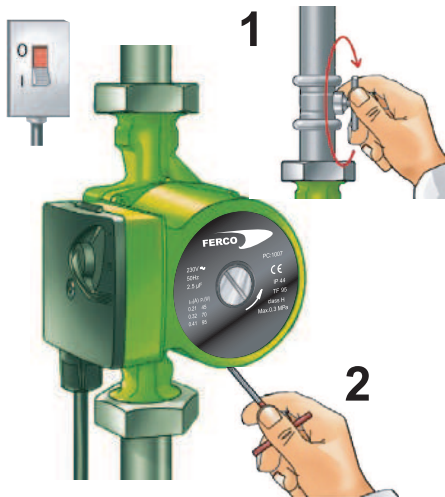

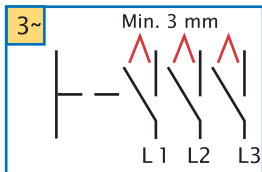
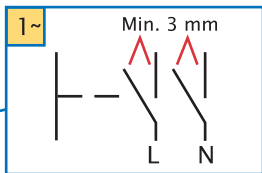
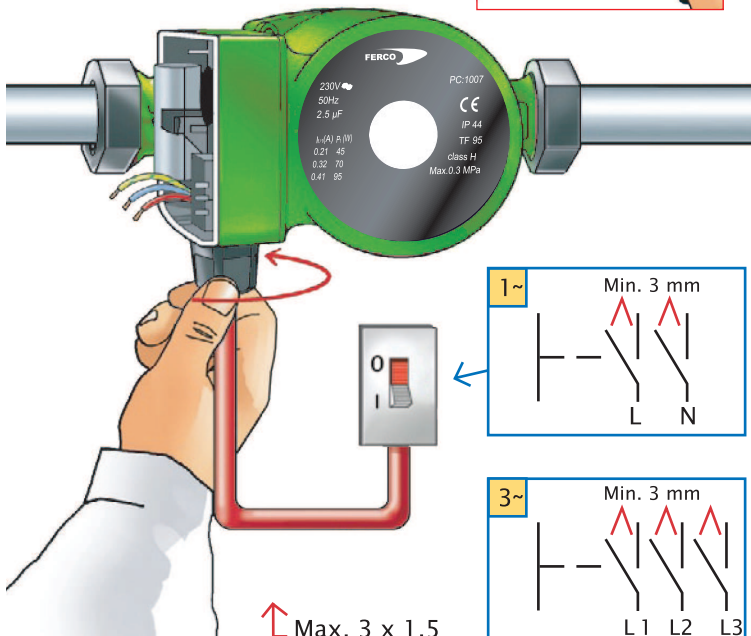
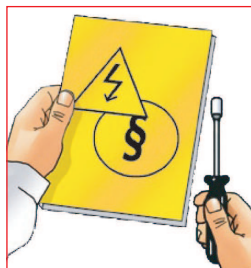

Max. 3 x 1,5
 Max. \varnothing 10mm

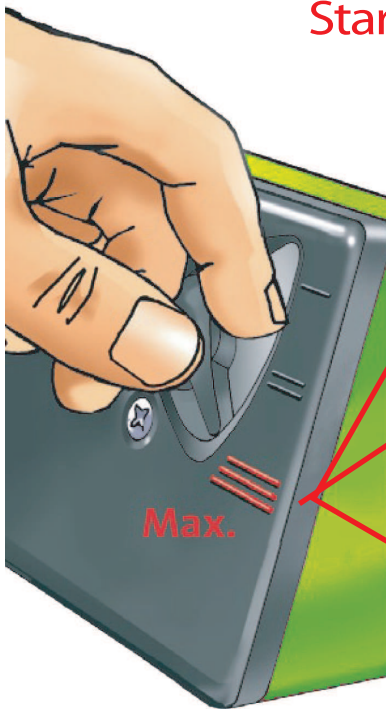

Start

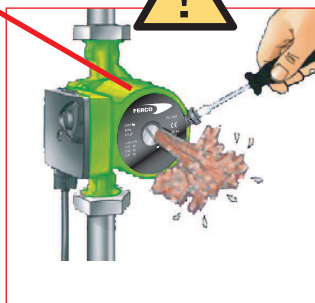
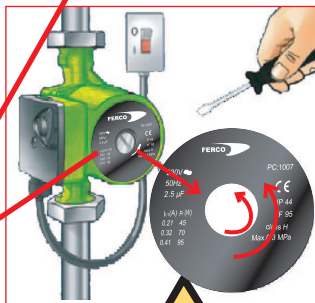
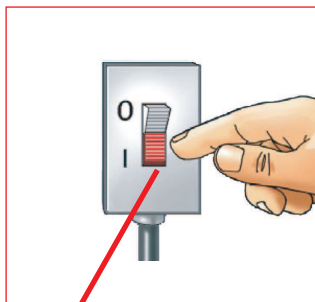

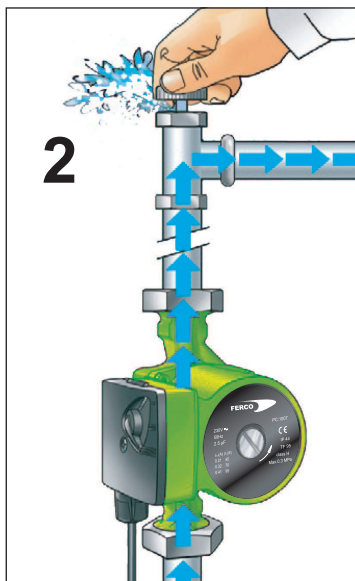
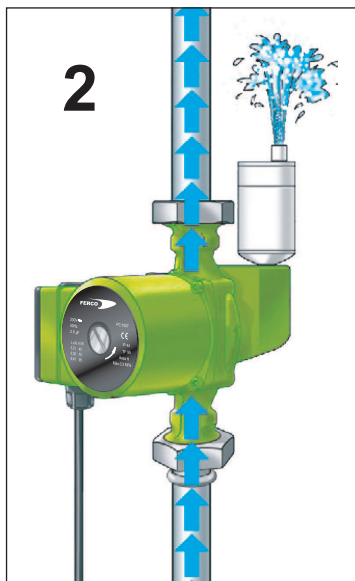
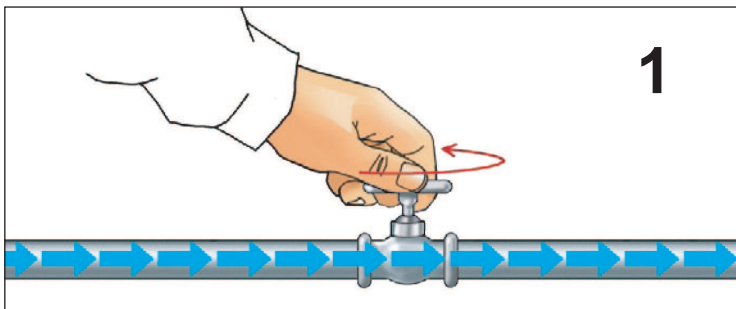

RS25/60

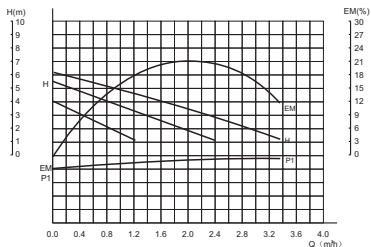
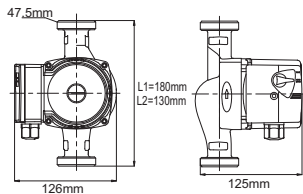

RS15/60

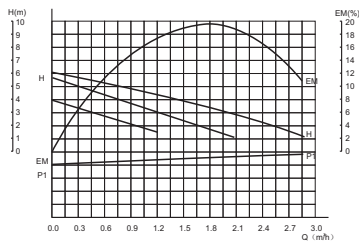
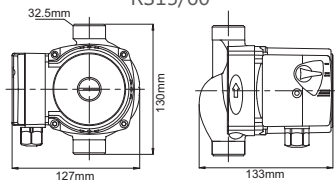

RS25/80

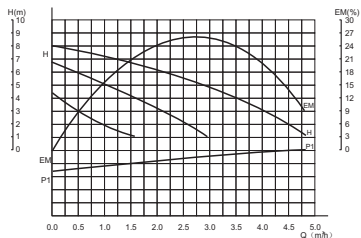
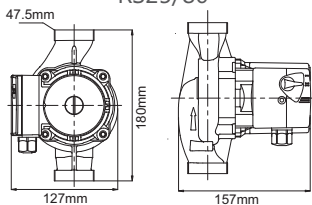

DATOS TÉCNICOS

MODELO BOMBA	POTENCIA W	MAX.FLUJO L/Min	ALTURA M	ENTRADA/SALIDA IN	NW Kg
RS15/60-3	93/67/46	48/35/21	6/5/3	1"	2.2
RS25/60-8	93/67/46	55/38/22	6/5/3	1 1/2"	2.4
RS25/80-8	165/115/75	80/48/25	8/7/5	1 1/2"	3.4



Pol. Ind. Llanos de Jarata
C/ Alejandro Goicoechea s/n
Apdo. Correos 131
Montilla 14.550 (Córdoba)
Telf. +34 957 66 40 50 // Fax. +34 957 65 44 82
fercofloor@fercofloor.com

www.fercofloor.com