



INSTALLATION INSTRUCTIONS

Accessory
VISOR
P/N 08R71-MKK-D00

Application
CRF1000A/A2/D/D2

Publication No.
MII
Issue Date
November 2017

Honda Dealer: Please give a copy of these instructions to your customer.

PARTS LIST

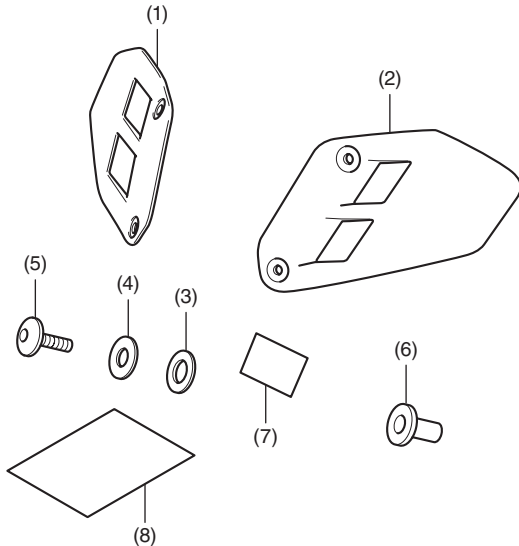

No.	Description	Qty
(1)	Right visor	1
(2)	Left visor	1
(3)	Rubber washer	4
(4)	Washer	8
(5)	5 mm screw	4
(6)	Well nut	4
(7)	Protector film	2
(8)	URL paper	1

TOOLS AND SUPPLIES REQUIRED

- Hex wrench (5 mm)
- Electric drill
- Drill bit (5 mm)
- Isopropyl alcohol
- Shop towel
- Torque wrench

TORQUE CHART

Tighten all screws, bolts, and nuts to their specified torque values. Refer to the Service Manual for the torque values of the removed parts.

Item	N-m	kgf-m	lbf-ft
5 mm screw	0.4	0.04	0.3

INSTALLATION

▲ CAUTION

- To prevent burns, allow the engine, exhaust system, radiator, etc., to cool before installing the accessory.

NOTE:

- Heat the bonding surfaces with a hair dryer if the ambient air temperature is below 70°F (21°C).
- The adhesive reaches full strength in 72 hours. Wait at least 24 hours before riding your motorcycle.

- Remove the main seat as shown.
 - Perform this step on CRF1000A/D only.

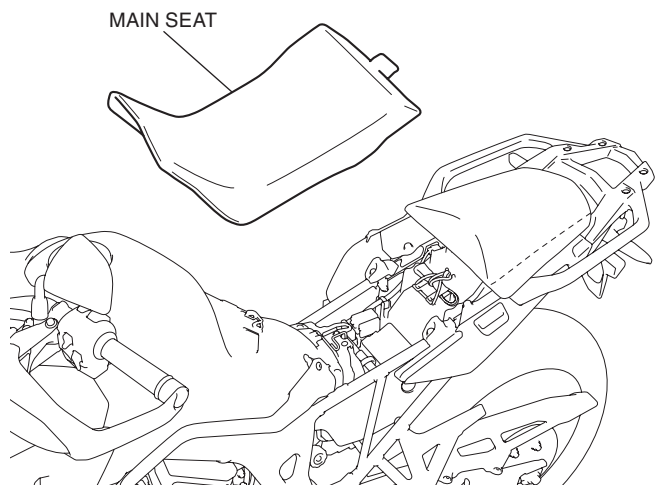

- Remove the screws as shown.
 - Perform this step on CRF1000A/D only.

<Left side>

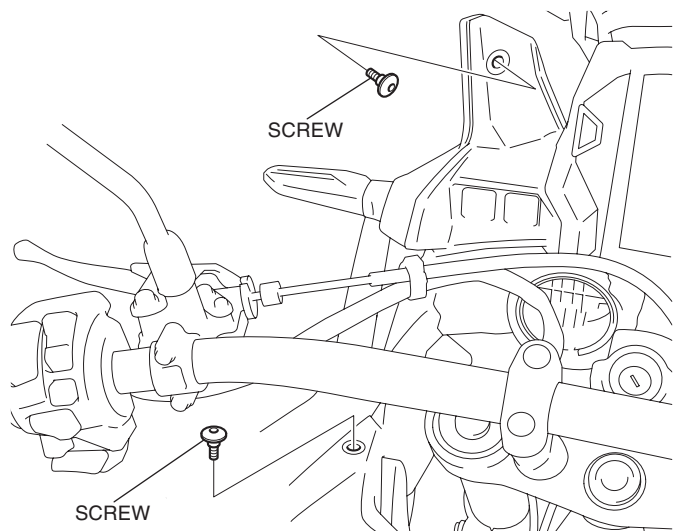

3. Remove the left tank side cover as shown.
- Perform this step on CRF1000A/D only.

<Left side>

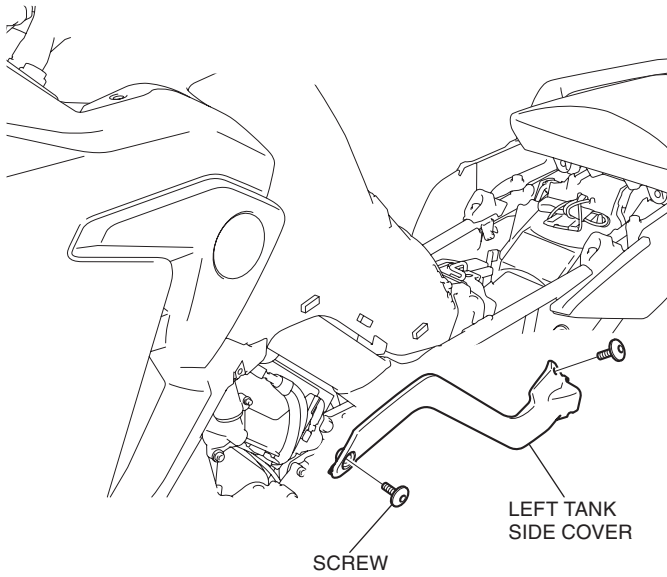

4. Remove the front spoiler as shown.
- Perform this step on CRF1000A/D only.

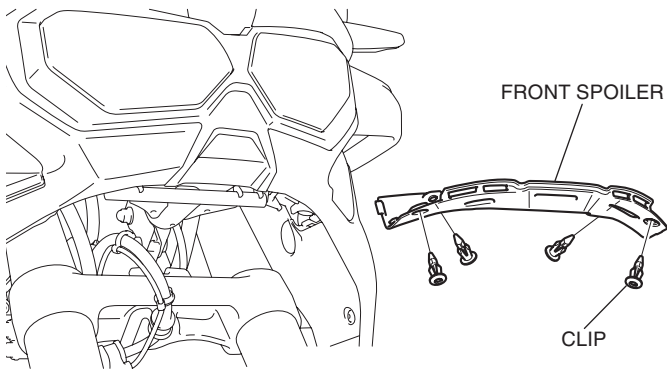

5. Remove the clips as shown.
- Perform this step on CRF1000A/D only.

<Left side>

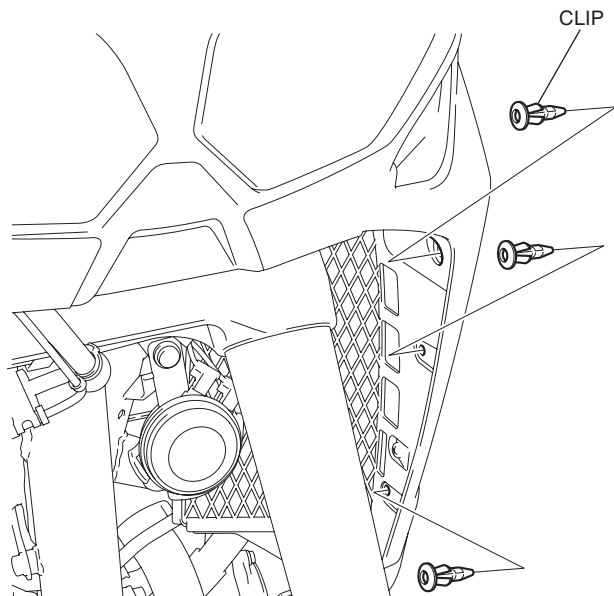

6. Remove the left middle cowl as shown.
- Perform this step on CRF1000A/D only.

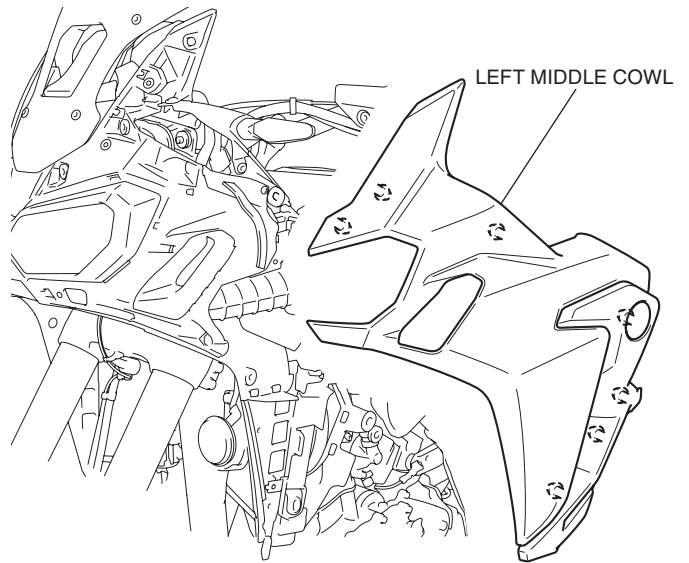

7. Drill at the mark of the left middle cowl as shown.
- Perform this step on CRF1000A/D only.
 - Drill holes at the center of the mark.
 - Remove the any burrs from the edge of the hole.

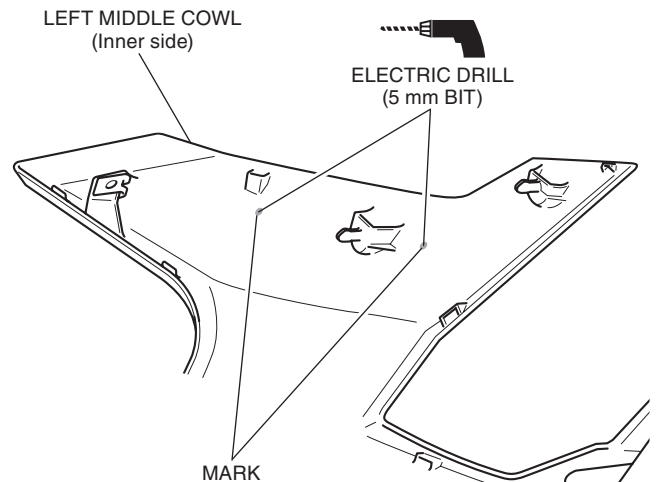

8. Install the well nuts as shown.
- Perform this step on CRF1000A/D only.

<Left side>

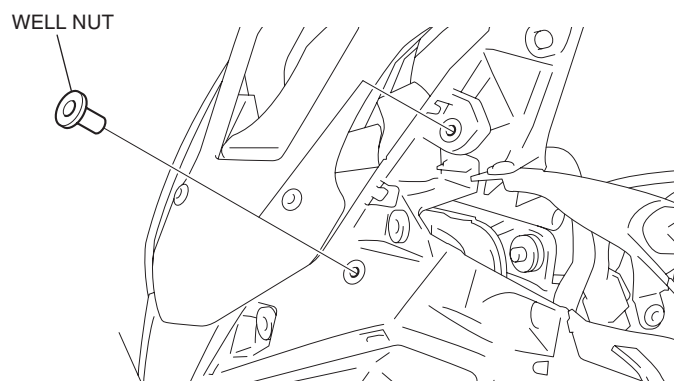

9. Install the left middle cowl in the reverse order of removal.

10. Remove the screws as shown.

- Perform this step on CRF1000A2/D2 only.

<Left side>

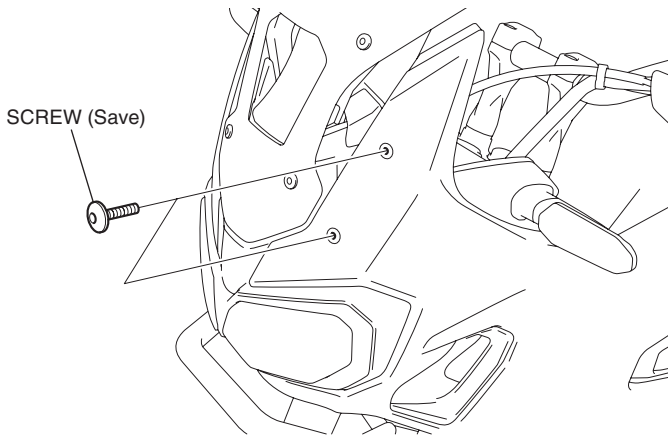

11. Clean the surface of the area shown using an isopropyl alcohol.

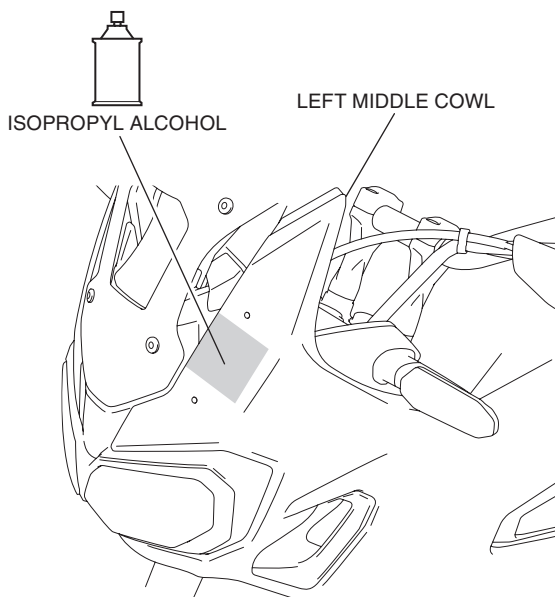

12. Attach the protector film as shown.

PROTECTOR FILM
Remove the adhesive backing before attaching.

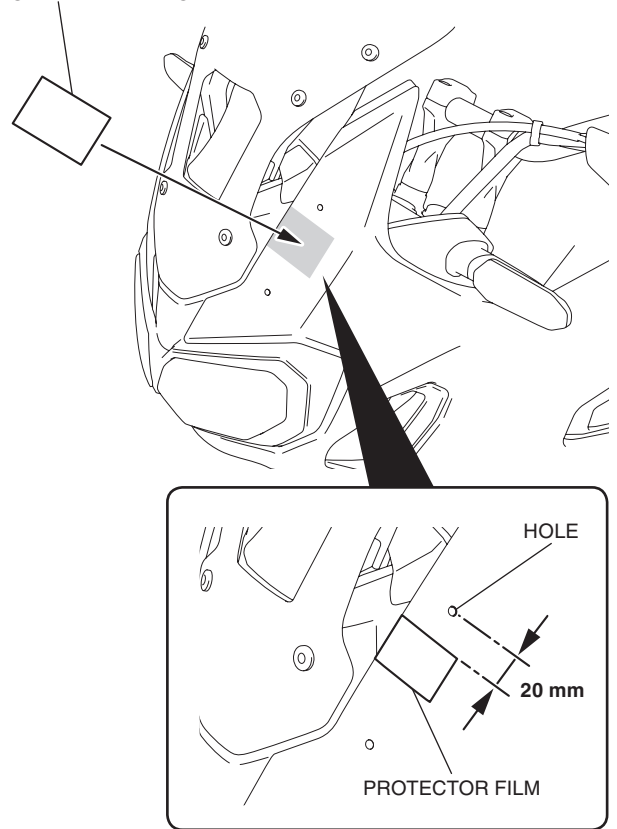

13. Install the left visor as shown.

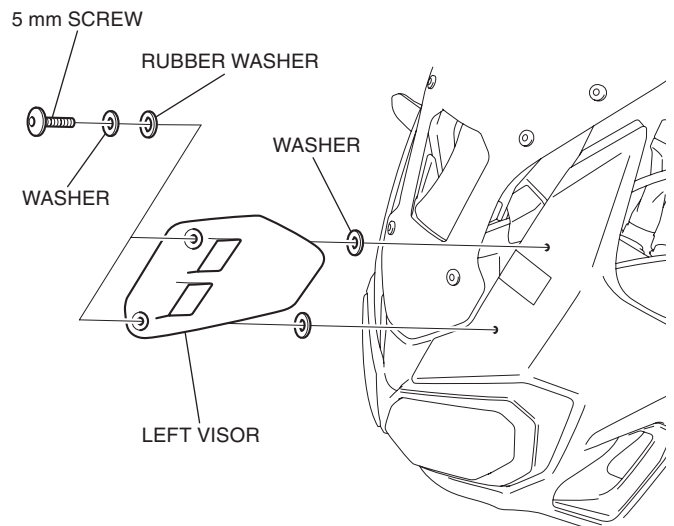

14. Install the right visor in the same manner as the left side.

15. Install the motorcycle's parts in the reverse order of removal.