

E1220KV

f = 12.0mm F2.0 3 Megapixel lens for 1/1.8 type Format Board Cameras, No Iris

Model No.	E1220KV		Effective Lens Aperture	Front	φ 13.0mm		
Focal Length	12.0mm			Rear	φ 8.1mm		
Max. Aperture Ratio	1:2.0		Distortion		+0.04% (γ=4.32)		
Max. Image Format	6.9mm x 5.2mm (φ 8.64mm)		Back Focal Length		13.34mm		
Operation Range	Iris	—		Flange Back Length		—	
	Focus	0.2m - Inf.		Mount		M12 P=0.5mm	
Object Dimention at M.O.D.	1/2 type	11.1cm x 8.3cm (φ 13.9)		Dimensions		φ 17.0mm x 34.4mm	
	1/3 type	8.3cm x 6.2cm (φ 10.4)		Weight		12.0g	
Coating	MgF2 Single Coat (All Surfaces λ = 510nm)						
Angle of View	D	1/1.8 type	39.50°	1/2 type	36.80°	1/3 type	28.06°
	H		32.05°		29.84°		22.61°
	V		24.44°		22.61°		17.05°

Dimensions

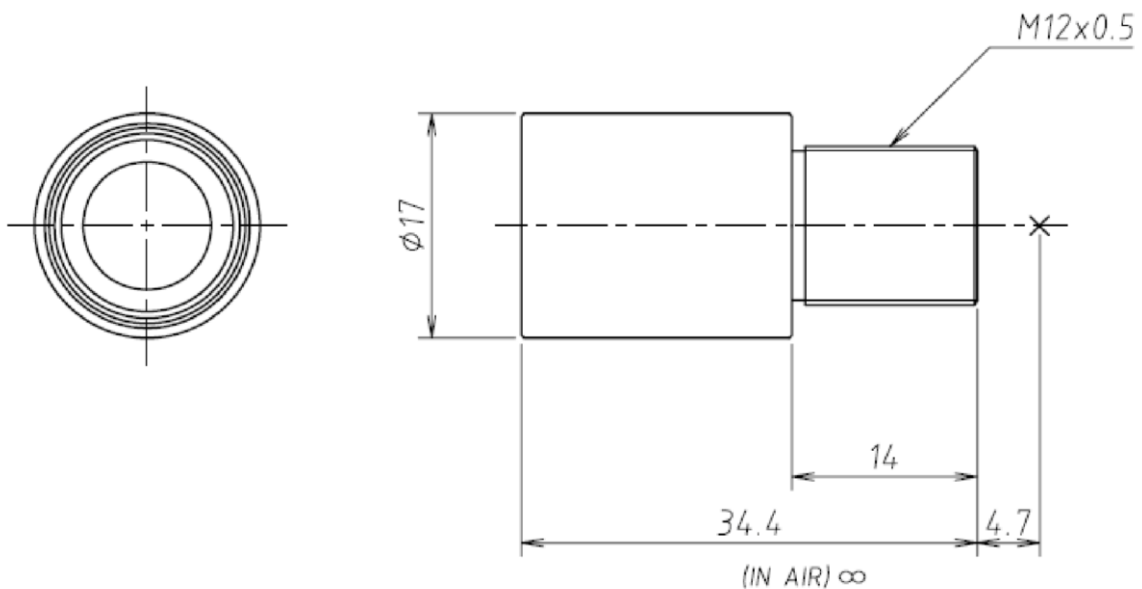

Specification is subject to change without any notice. 2009.3