

SERIE ORO FIXED 68B407A6

The 68B407A6 brake disc is synonymous with reliability

Brembo Serie Oro brake discs are fully interchangeable with an Original Equipment brake disc. The Serie Oro fixed discs are made from a single piece of stainless steel. Resulting from a specific study of machining tolerances, the special conformation of Brembo discs allows braking torque to be transmitted more effectively while offering better resistance to thermal and mechanical stress. The Serie Oro was the range with which Brembo entered the racing world in the mid-1970s, quickly becoming the industry benchmark for discs.

- ✓ OE-equivalent
- ✓ Brembo quality
- ✓ Safety
- ✓ Performance
- ✓ Durability
- ✓ Sports driving

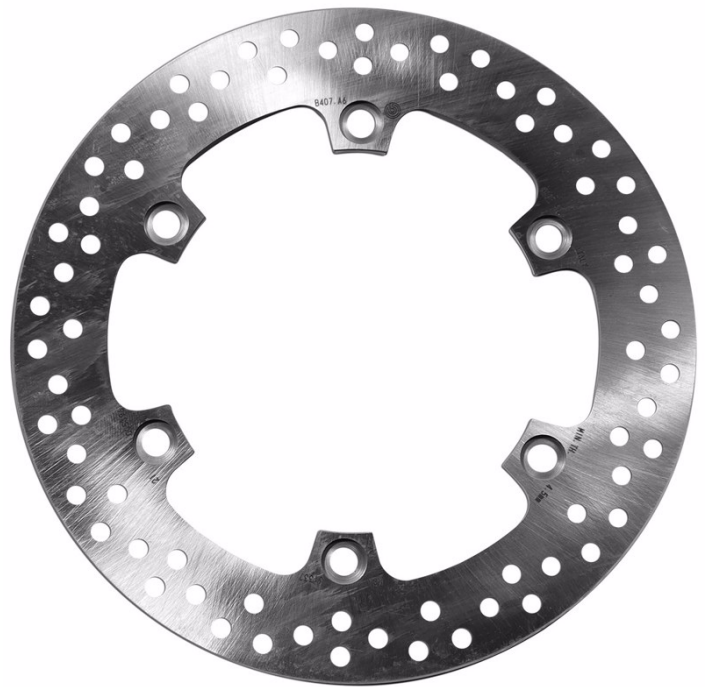

Technical specifications

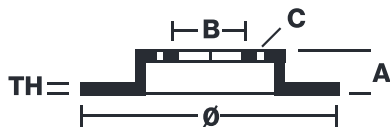

Diameter	Thickness	Number of holes
256 mm	5 mm	6
Hole diameter	Centering	Brake disc type
10,5 mm	144 mm	Fixed
Surface width	Holes fixing	
	10,5 mm	
Units per box		
1		

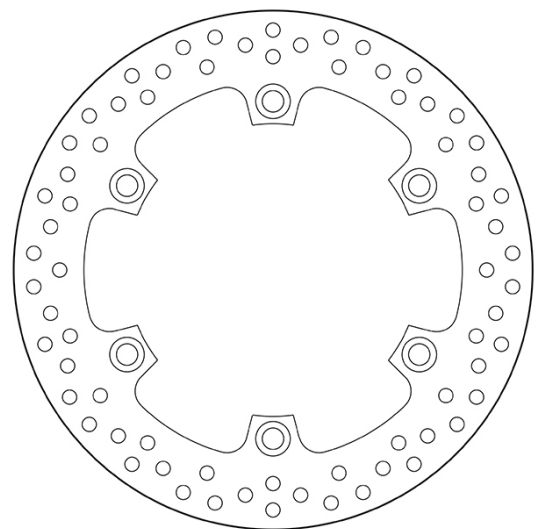

COMPATIBLE VEHICLES

HONDA

HONDA	Forza ABS	300	2014 - 2020
HONDA	Forza ABS	125	2015 - 2020
HONDA	Forza X/ Xe	250	2008 - 2014
HONDA	CB F	1300	1998 - 2000
HONDA	CB S	1300	2011 - 2015

HONDA	CB X-11	1100	2000 - 2003
HONDA	CBR F	1000	1989 - 1992
HONDA	CBR Xx	1100	1997 - 2004
HONDA	CBR XX Super Blackbird	1100	1997 - 2007
HONDA	FJS Silverwing	600	2001 - 2008
HONDA	FJS Silverwing	400	2006 - 2008
HONDA	NS R	400	1985 - 1987
HONDA	NSS Forza	300	2018 - 2020
HONDA	NSS Forza	125	2015 - 2019
HONDA	SH 30Anni	300	2015 - 2015
HONDA	SH ABS	300	2006 - 2015
HONDA	SH i	300	2007 - 2019
HONDA	SH i SH30	300	2015 - 2018
HONDA	SH i Sport ABS	300	2018 - 2021
HONDA	VF F, FII	500	1984 - 1986
HONDA	XL-L Varadero/ ABS	1000	2003 - 2011