

Twist-Lock® Devices
 20A, 3 Phase Y 277/480V AC, 4 Pole, 5 Wire
 Grounding
 Insulgrip® Flanged Inlet

HUBBELL



Features

- Backwired terminations for ease of installation
- #10-32 Multiple drive terminal screws (Slotted, Phillips, Robertson)
- Mounting screws included

Ordering Information

| Description | Device Color | UPC | Catalog Number |
|--------------------------|--------------|--------------|----------------|
| Nylon casing, back wired | White | 783585038629 | HBL2525 |

Listings

Listed to UL 498
 Fed.Spec. W-C-596
 Certified to CSA C22.2 No.42

Specifications

| | |
|-------------------|---|
| Housing | Nylon |
| Terminal Retainer | Clear polycarbonate |
| Blades | Brass |
| Terminal Screws | #10-32 Brass (Phillips / Slotted / Robertson) |
| Terminal Clamp | Cold rolled steel – nickel plated |
| Assembly Screws | Steel - nickel plated |
| Mounting Screw | Nickel plated brass |

Performance

| | |
|-------------------------|--|
| Electrical | |
| Current Interrupting | Certified for current interrupting at full rated current |
| Dielectric Voltage | Withstands 2,000V minimum |
| Mechanical | |
| Terminal Accommodation | #16 AWG - #8 AWG solid or stranded copper wire only. |
| Terminal Identification | Terminals identified in accordance with UL 498 |
| Environmental | |
| Flammability | HB or better per UL94/CSA 22.2 No.0.17 |
| Moisture Resistance | IP20 Suitability |
| Operating Temperatures | Maximum Continuous 75°C. Minimum -40°C (w/o impact) |



20A 3ØY
 277/480V AC
 NEMA L22-20P
 UL/CSA
 5 HP

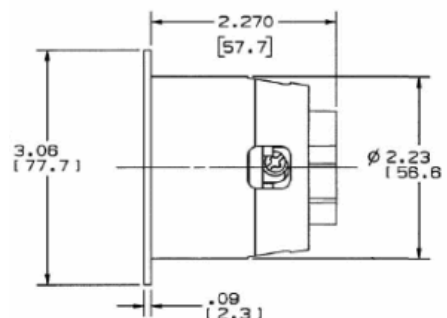

Accessories

| | |
|-------------------------|---------|
| Connector | HBL2523 |
| Weatherproof Lift Cover | WP2 |

Resources

Customer Use Drawing
 eCatalog

Dimensions in Inches (mm)

Hubbell Wiring Device-Kellems • Hubbell Incorporated (Delaware) • 40 Waterview Drive • Shelton, CT 06484

Phone (800) 288-6000 • Fax (800) 255-1031 • Specifications subject to change without notice.

