

**Twist-Lock® Devices**  
**30A, 2 Pole, 3 Wire, 240VAC, Line to Neutral**

# HUBBELL

## Insulgrip® Receptacle

### Features

- Wire restraint recess for both back and side wiring, greatly reduces the possibility of loosening the terminal connection
- Face color coding by voltage facilitates locating and mating of proper devices
- All-brass mounting and grounding system provides a lower resistance ground path and greater resistance to corrosion than steel mounting systems



30A 240V AC  
 NEMA L25-30R  
 UL/CSA



### Ordering Information

Description	Device Color	UPC Number	Catalog Number
Black Nylon	Black	783585580319	HBL2600

### Listings

Listed to UL 498  
 Fed. Spec. W-C-596  
 Certified to CSA C22.2 No.42

### Specifications

Face	Nylon
Base	Glass-Reinforced thermoplastic polyester (RTP)
Contacts	Brass
Terminal Screws	#10-32 Brass
Mounting Strap	Brass

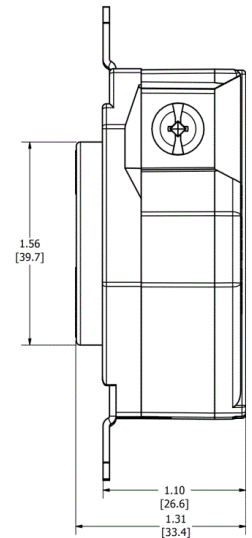
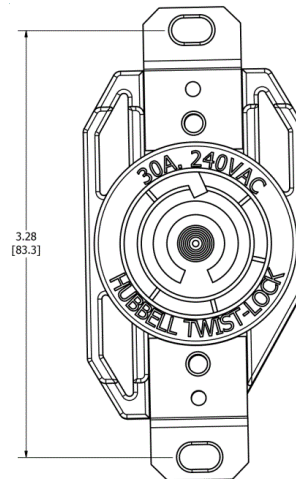

### Performance

#### Electrical

Current Interrupting	Certified at full rated current
Dielectric voltage	2,000V minimum

#### Mechanical

Terminal Accommodation	#16 - #8 AWG stranded
Terminal Identification	Terminals identified in accordance with UL498

#### Environmental

Flammability	HB or better per UL94/CSA 22.2 No.0.17
Moisture Resistance	IP20 Suitability
Operating Temperatures	Maximum Continuous 75C Minimum -40C (w/o impact)

### Complementary Products

Wallplate or Weatherproof Cover	1.60" Opening
Plug	HBL2601

### Online Resources

eCatalog

Dimensions in Inches (mm)

Hubbell Wiring Device-Kellems • Hubbell Incorporated (Delaware) • 40 Waterview Drive • Shelton, CT 06484

Phone (800) 288-6000 • Fax (800) 255-1031 • Specifications subject to change without notice.

